

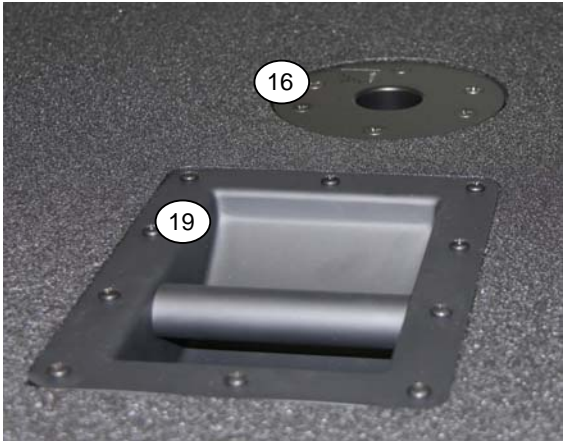

PSA1S Quick Guide

**Real Gear.
Real People.**

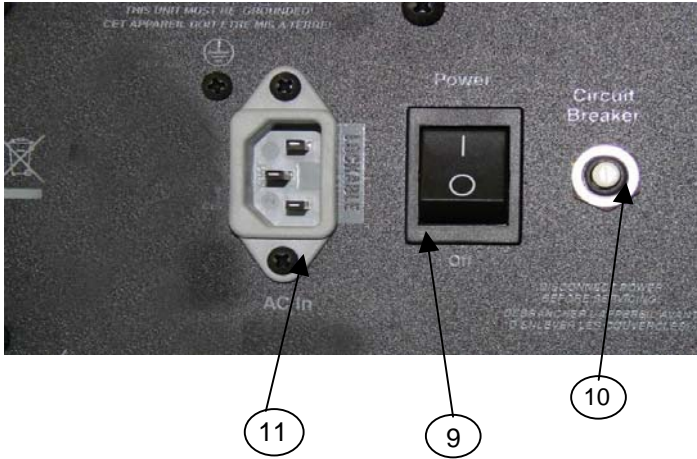
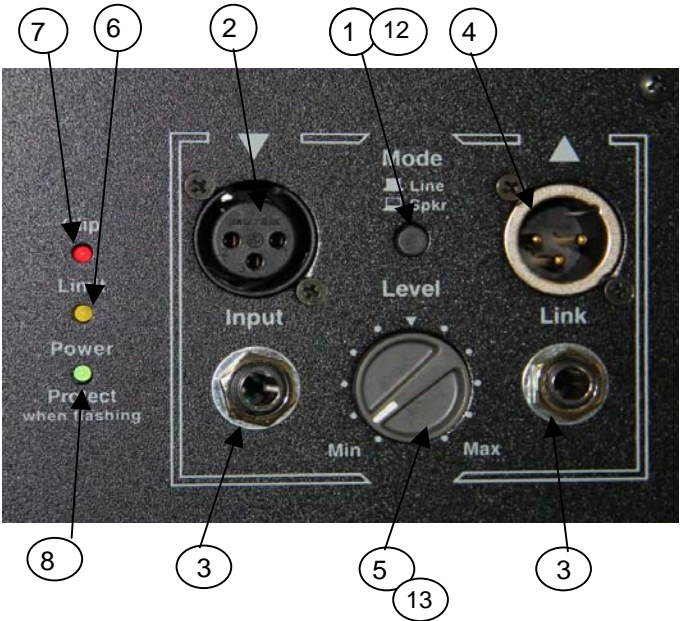

PART#	DESCRIPTION
1	3522 DPDT MINI PC VERT SNP ALT <i>Line/Speaker Mode Switch</i>
2	4010 XLR FEML PCB MT VERT 24MM AA-SERIE <i>Input Jack</i>
3	4063 1/4IN ISO JCK PCMT VT STER RT SWT <i>Input and Link Jack</i>
4	4135 XLR MALE PCB MT VERT 24MM BA-SERIE <i>Link Jack</i>
5	4434 10K B LIN 9MM DETENT <i>Level Control</i>
6	6400 YEL 3MM LED 1V9 6MA HIGH EFF <i>Limit L.E.D.</i>
7	6405 RED 3MM LED 2V0 20MA BRT <i>Clip L.E.D.</i>
8	6408 GRN 3MM LED 1V9 5MA FROSTED <i>Power and Protect L.E.D.</i>
9	3587 DPDT ROKR SW QUIK 250°AC/PWR ON-OFF <i>Power Switch</i>
10	3606 12.00 AMP CIRCUIT BREAKER
11	4088 IEC POWER V-LOCK INLET <i>A.C. in</i>
12	8637 ROUND PUSH BUTTON 1/4" BLK 24MM <i>Line/Speaker Mode Switch Knob</i>
13	8653 LS701-801-2100 POINTER AT 12 KNOB <i>Level Knob</i>
14	3074 POWER CORD 3M V-LOCK (N.A)
15	7517 12" 4R 600WPGM SPKR
16	9170 STAND ADAPTER CAST
17	8529 RUBBER FOOT 65 X 20MM <i>On side to secure stacking</i>
18	8545 RECESSED RUBBER BUMPER WITH WASHER
19	8565 BAR HANDLE ALL METAL RECTANGULAR
20	9970 RIGID CASTER