

DP-8 HALF DAMPER PEDAL Owner's Manual

■ Introduction

Thank you, and congratulations on your choice of the Roland DP-8 Half Damper Pedal. The DP-8 pedal controls the half damper function, a must for authentic piano performances. You can use the pedal after connecting it to a Roland digital piano.

To get the most from this device and ensure years of trouble-free use, be sure to read this manual carefully, then keep the manual somewhere handy so you can refer to it whenever necessary.

■ Features

You can select the function appropriate for the application you have in mind for the pedal.

○ Half Damper Control

This allows you to perform using the half damper function.

○ Switch Control

The pedal functions as a pedal switch, just like the Roland DP-2 and DP-6.

Use the function switch on the side of the pedal to select the function you want to use.

■ Connecting the Pedal

- 1 Connect the pedal's cord to the Damper Pedal jack (or Hold Pedal jack) of the device to which the pedal is being connected.

* Note that connecting to any connector other than those specified above may result in damage to the unit.

- 2 Set the DP-8's function switch to "Continuous."

* With instruments that do not support the use of the half damper function, the pedal may not function as hoped for. Should this be the case, move the DP-8's function switch to the "Switch" position.

■ Panel Descriptions

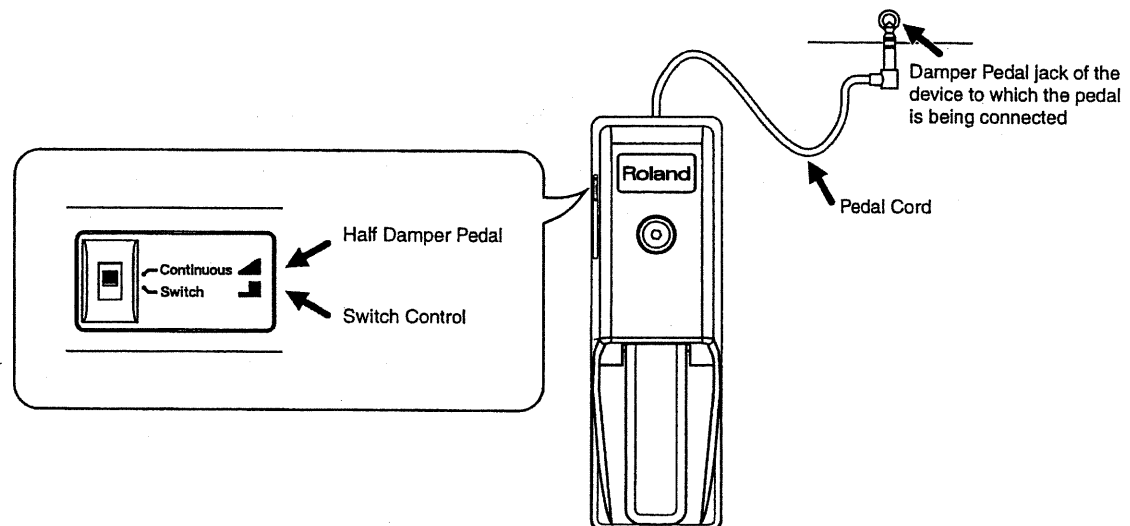

■ Main Specifications

Pedal Cord	1.3 m
Function Switch	Continuous/Switch
Dimensions	68.4 (W) x 218.4 (D) x 57.8 (H) mm 2-3/4" (W) x 8-5/8" (D) x 2-5/16" (H) inch
Weight	0.57 kg 1 lb 5 oz

* In the interest of product improvement, the specifications and/or appearance of this unit are subject to change without prior notice.

Roland®

17041305

UPC

17041305



18981